

WARING COMMERCIAL

NuBlend Commercial Blenders

BB180

44 oz. Eastman container

BB180S

32 oz. stainless steel container

Marked for Deletion

NDG180 / Next Day Gourmet

44 oz. Eastman container

(on 3/6/2013)

NEXT DAY
GOURMET
REORDER #842117

028214

Name Plate Label

NOTE:

3 Part Changes

Starting With **Unit Date Code 130308** (3/8/2013)

That Can **NOT** be

Interchanged With Previous

Unit Date Codes

Blade Assembly - Coupling - Motor

Unit Date Code

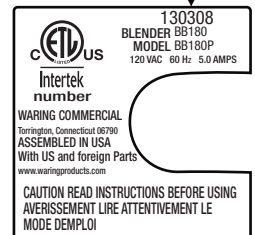

SAMPLE Data Decal

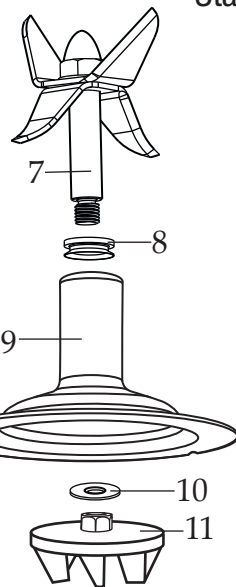
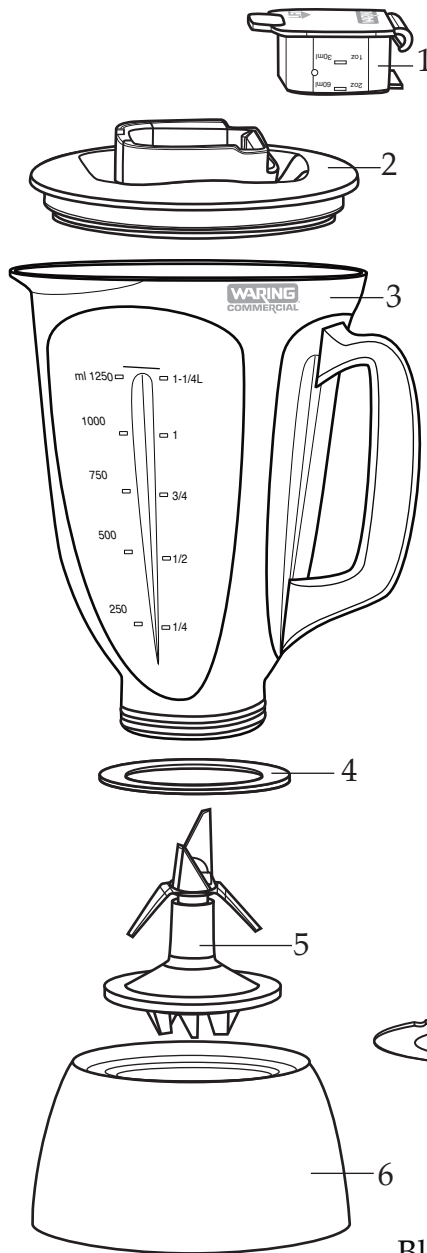

503408

Blending Assembly
(on units after 3/8/2013)

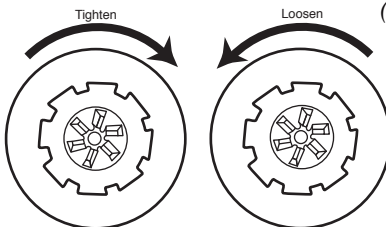

Jar Upside Down with Jar Bottom Facing You



013304

NSF Seal

Unit Information

Limited 2 Year Warranty

60Hz - 5 Amps

3/4 HP Motor

Hamilton Beach 901, 908 & 909

Jars Can Be Used On This Unit

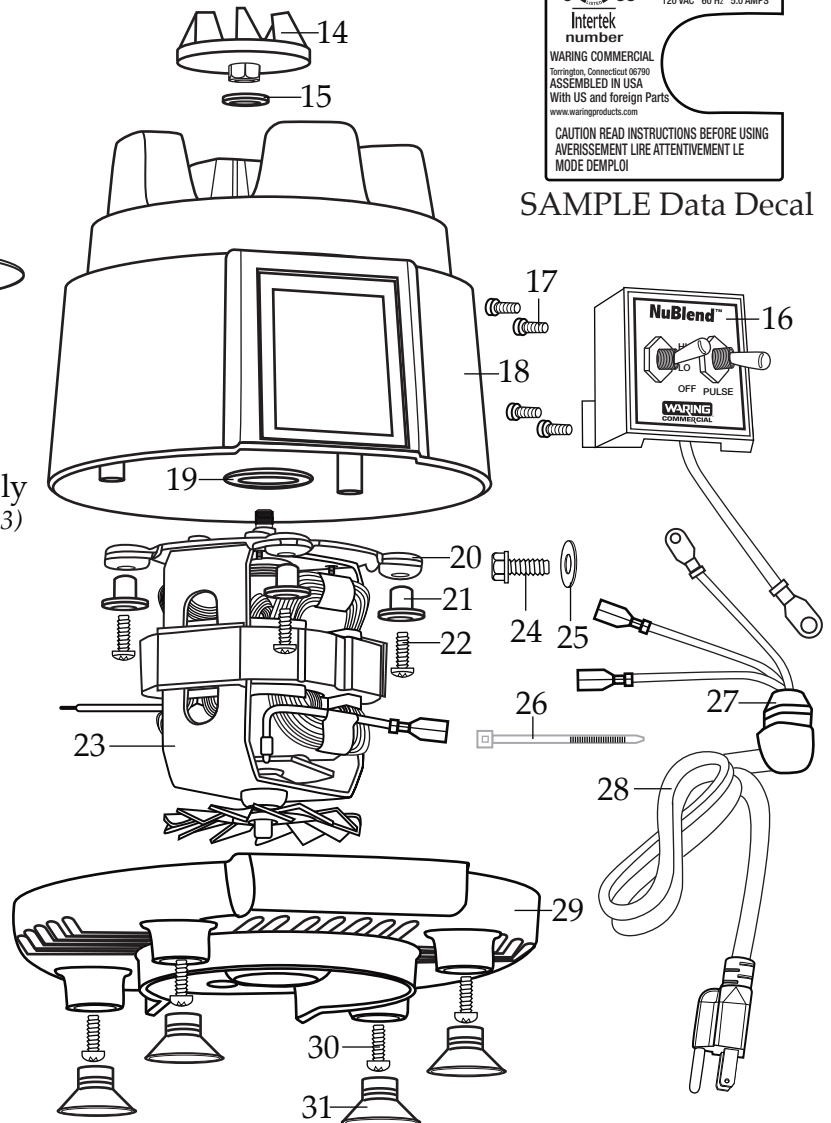

Catalog Model
BB180 BB180P
(on units after 2/15/2010)
BB180 MT (Type 25)
(on units after 10/5/2004)
BB180T
(on units after 8/25/2003)
BB180

Catalog Model
BB180S BB180S
(on units after 2/15/2010)
BB180S MT (Type 25)
(on units after 10/5/2004)
Marked for Deletion
NDG180 BB180P
(on units after 2/15/2010)
BB180 MT (Type 25)
(on units after 10/5/2004)

WARING
COMMERCIAL
314 Ella T. Grasso Ave.
Torrington, CT 06790
Tele. 1-800-269-6640
Fax 860-496-9017
www.waringcommercialproducts.com

Illustration#	Part#	Description
1	026282-E	Cover Lid <i>(changed after 5/14/2010)</i>
2	026281-V	Jar Lid <i>(changed after 5/14/2010)</i>
3	026280-E	44 oz. Eastman Container <i>(changed after 5/14/2010)</i>
4	026284	Jar Seal
5	503408 503377	Blending Assembly <i>(on units after 3/8/2013)</i> Blending Assembly
6	026285	Jar Bottom
7	503407 503378	Blade Assembly <i>(on units after 3/8/2013)</i> Blade & Shaft Assembly
8	027716	V Seal
9	503358	Stainless Steel Bearing Holder
10	030426	Nylon Washer
11	032453 027097	Coupling <i>(on units after 3/8/2013)</i> Coupling
12	026852-V	Jar Cover
13	026851	32 oz. Stainless Steel Container
14	032453 027097	Coupling <i>(on units after 3/8/2013)</i> Coupling
15	035756 026413 003507	Cap Washer <i>(on units after 10/31/2016)</i> Cap Washer <i>(on units after 5/26/2011)</i> Washer
16	028209	Switch Assembly <i>(on units after 6/23/2006)</i>
17	026267 028259	Screw (4 required <i>on units after 6/3/2002</i>) Screw (4 required <i>obsolete</i>)
18	028212	Top Housing <i>(changed after 6/23/2006)</i>
19	026269	Upper Motor Mount
20	026841	Rubber Bushing (4 required)
21	026690	Eyelet (4 required)
22	026716	Screw (4 required)
23	033056 032376 029794	ECM Motor <i>(on units after 8/9/2013)</i> Chiaphua Motor <i>(on units after 3/1/2013)</i> ECM Motor <i>(changed after 2/22/2010)</i>

Catalog Model
BB180 BB180P
(on units after 2/15/2010)
BB180 MT (Type 25)
(on units after 10/5/2004)
BB180T
(on units after 8/25/2003)
BB180

Catalog Model
BB180S BB180S
(on units after 2/15/2010)
BB180S MT (Type 25)
(on units after 10/5/2004)
Marked for Deletion
NDG180 BB180P
(on units after 2/15/2010)
BB180 MT (Type 25)
(on units after 10/5/2004)

WARING
COMMERCIAL
314 Ella T. Grasso Ave.
Torrington, CT 06790
Tele. 1-800-269-6640
Fax 860-496-9017
www.waringcommercialproducts.com

Illustration#	Part#	Description
24	027278	Ground Screw (1 required <i>on units after 7/9/2008</i>) (2 required <i>on units after 11/2/2007</i>) (3 required <i>on units after 7/26/2006</i>) (1 required <i>on units after 6/23/2006</i>)
	002436	Ground Screw (1 required)
25	002943	Lock Washer (2 required <i>on units after 11/2/2007</i>) (4 required <i>on units after 6/22/2006</i>) (1 required)
26	013731	Cable Tie (2 required <i>on units after 6/23/2006</i>)
27	013680	Strain Relief
28	502835	Cord Set (<i>on units after 6/23/2006</i>)
	502828	Cord Set
29	028580-X	Bottom Housing (<i>on units after 11/2/2007</i>)
	026464	Bottom Housing (<i>on units after 2/25/2005</i>)
	027063	Bottom Housing ONLY (<i>with hole for reset switch on units after 9/4/2003</i>)
	502919	Bottom Housing with Reset Switch Assembly (<i>on units after 9/4/2003</i>)
	026464	Bottom Housing
30	026276	Screw (4 required)
31	026278	Suction Cup Foot (4 required)

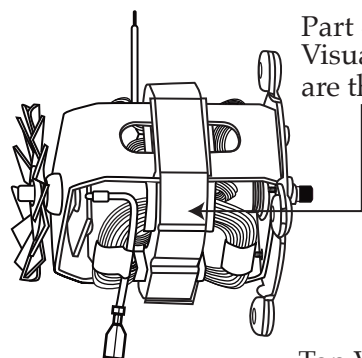

Part # is printed on each motor.
 Visually you may think motors
 are the same **but they are not.**

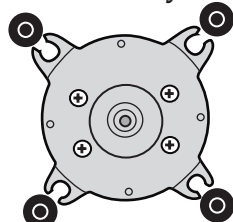

Top View 029794 or 033056 Motors

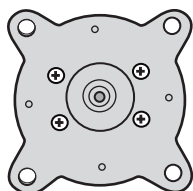

Top View
 If you have this
 type of motor
 See BB180 " (C) " Graphic



027097
 Coupling
(for 029794 motor)

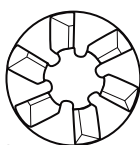

503377
 Blending Assembly
(for 029794 motor)

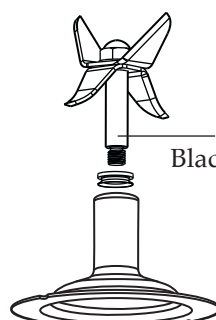

503378
 Blade Assembly



027097
 Coupling

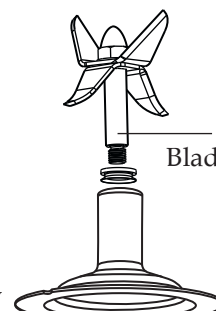

503407
 Blade Assembly



032453
 Coupling

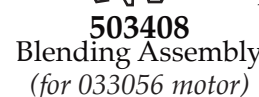

503408
 Blending Assembly
(for 033056 motor)

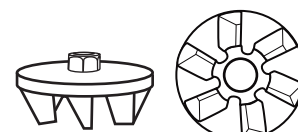

032453
 Coupling
(for 033056 motor)

Catalog Model
BB180 BB180P
(on units after 2/15/2010)
BB180 MT (Type 25)
(on units after 10/5/2004)
BB180T
(on units after 8/25/2003)
BB180

Catalog Model
BB180S BB180S
(on units after 2/15/2010)
BB180S MT (Type 25)
(on units after 10/5/2004)
Marked for Deletion
NDG180 BB180P
(on units after 2/15/2010)
BB180 MT (Type 25)
(on units after 10/5/2004)

WARING
COMMERCIAL
314 Ella T. Grasso Ave.
Torrington, CT 06790
Tele. 1-800-269-6640
Fax 860-496-9017
www.waringcommercialproducts.com

Parts No Longer Used *(limited availability)*

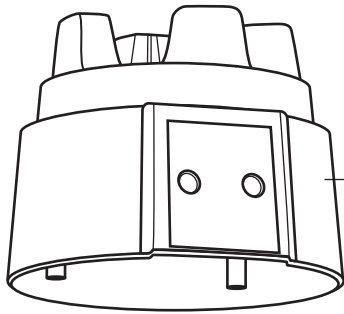

026402 - Name Plate
(last used on 6/23/2006)



009051 - Wire Nut *(last used on 6/23/2006)*

026368 - Top Housing
(last used on 6/23/2006)

502834 - Diode Assembly
(last used on 6/23/2006)
 (003262-diode)

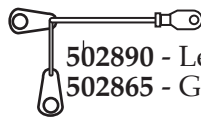
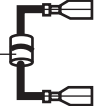

502890 - Lead Assembly-ground *(on units between 6/22/2006 - 11/2/2007)*

502865 - Ground Lead Assembly *(on units before 6/22/2006)*



026369 - Momentary On Switch
(last used on 6/23/2006)

029355 - Hi-Low-Off Switch *(last used on 6/23/2006)*
012698 - Hi-Low-Off Switch *(on units before 8/25/2003)*

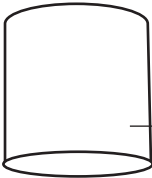

502833 - 8" Black Lead Assembly
(last used on 6/23/2006)

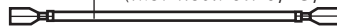

027053 - Shroud (baffle) *(last used 2/22/2010)*
026669 - Shroud (baffle) *(on units before 8/25/2003)*
Used with 027380 OLD motor ONLY



032261 Brush & Spring
 (2 required use with 029794)

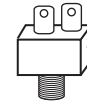

027052 - Reset Switch
(last used 2/25/2005)



014604 - Lock Washer
(last used 2/25/2005)



015184 - Hex Nut
(last used 2/25/2005)

Wiring Diagram

(on units after 7/9/2008)

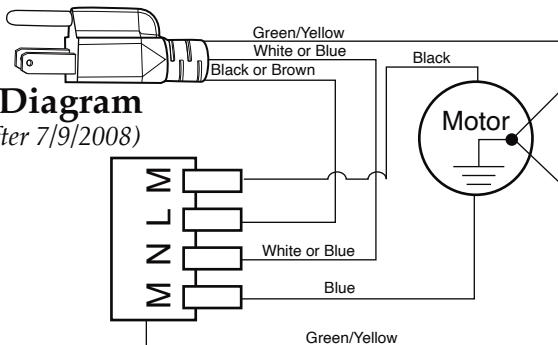

Wiring Diagram

(on units after 7/6/2006)

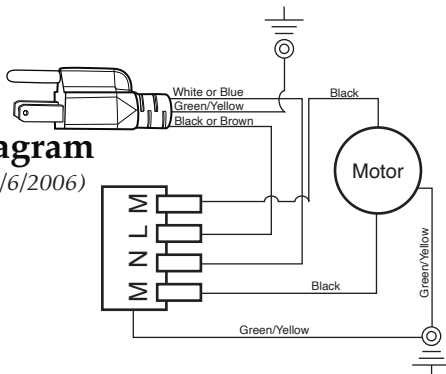

Wiring Diagram

(on units with reset)

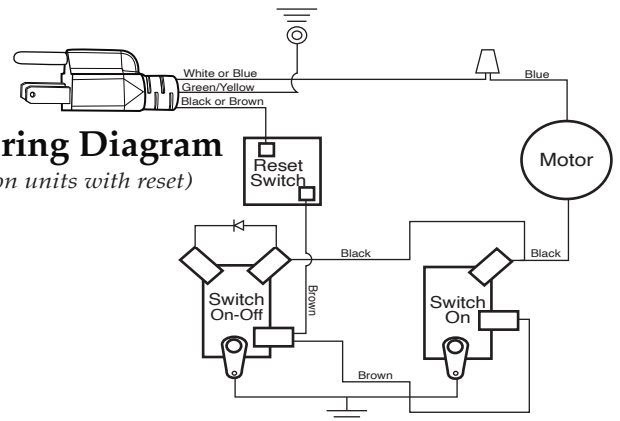

Wiring Diagram

(on units after 2/25/2005)

